

# Austrotherm EPS OPTIMIER®



**INTER-WALL  
HEAT INSULATION**

- ▶ **Inter-wall Thermal Insulation Applications**
- ▶ **0.034 W / mK Heat Conduction Coefficient\***
- ▶ **Lightweight, Flexible EPS Thermal Insulation Board**

\* This value shows how much heat the material used transmits, and the low heat transmission coefficient indicates that the material has better heat insulation.

# Austrotherm EPS OPTIMIER®

## Inter-wall Thermal Insulation Applications

### Product sheet

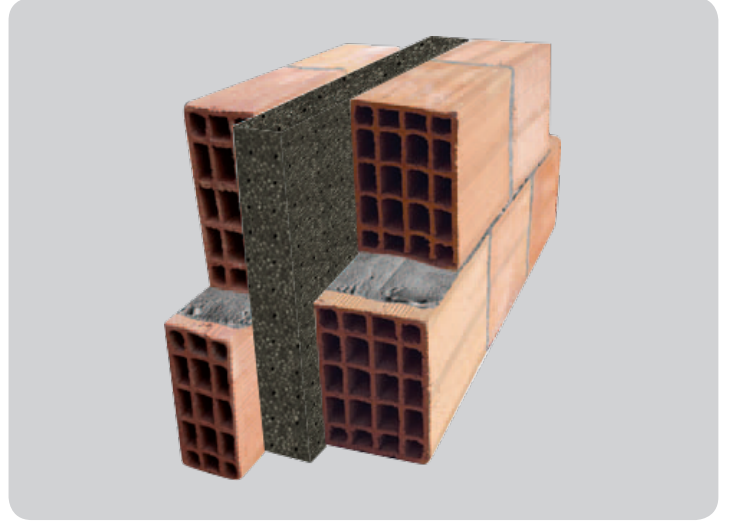

#### Description

It is an EPS thermal insulation board developed for thermal insulation between walls.

#### Properties:

It provides 15% better thermal insulation performance compared to the white EPS plate used in thermal insulation between walls. It is light and flexible and maintains dimensional stability.

#### Area of use:

It is used to provide thermal insulation between walls built with bricks, aerated concrete, pumice block and the like.

#### Storage Information:

It should be stored in a cool and ventilated, non-humid environment. Avoid contact with direct sunlight and being located near heat sources.

#### Quality certificates:

It complies with TS EN 13163: 2012 + A2 standard



#### Notice:

Not recommended for use in exterior thermal insulation applications in buildings.

#### Technical Specifications

**Product Type:** EPS 30

**Color:** Gray

**Thickness:** From 2cm to 10cm

**Size:** 50x100cm

**Edge Shape:** Straight

**Cell Content:** Air 98%, 2% Polystyrene

**Packaging:** PE nylon

Austrotherm EPS OPTIMIER®			
Technical Specifications	EPS 30	UNIT	CLASS
Thermal Conductivity Coefficient ( $\lambda$ )	0,034	W/mK	
Water Vapor Diffusion Resistance Factor - $\mu$	20-40	$\mu$	
Length Tolerance	$\pm 3$	mm	L3
Top Tolerance	$\pm 2$	mm	W2
Thickness Tolerance	$\pm 1$	mm	T1
Miter Tolerance	$\pm 2$	mm	S2
Surface Smoothness	$\pm 3$	mm	P3
Dimensional Stability in Fixed Conditions	$\pm 0,2$	%	DS(N)2
Dimensional Stability at Specific Temperature and Humidity	1	%	DS(70,-)1
Compressive Strength at 10% Deformation	$\geq 30$	kPa	CS(10)30
Flexural Strength	$\geq 60$	kPa	BS60
Long-Term Water Absorption-Partial Immersion	$\leq 0,5$	kg/m <sup>2</sup>	WL(T)0,5
Fire Resistance (TS EN 13501-1)	E		
Thickness	2-10	cm	
Dimensions	50x100	cm	
Usage Temperatures	(-50/75(+))	°C	

#### Austrotherm Yalıtım Malzemeleri San. Tic. Ltd. Şti.

**Head Office:** Sur Yapı Exen İstanbul, Tantavi Mah. Estergon Cad. F Blok No:24F Kat:39 Daire:448, 34764 Ümraniye/İstanbul  
Tel: +90 (216) 404 10 90, Faks: +90 (216) 404 10 99

**Dilovası Factory:** Mermerciler San. Sit. Köşeler Köyü Mevki, 37.Cadde, No:23, Dilovası, Kocaeli / Tel: +90 (262) 728 14 40, Faks: +90 (262) 728 14 44

**Turgutlu Factory:** Selvili Tepe Mah. Tic.ve San. Odası Bul. No:1 Turgutlu OSB Turgutlu, Manisa / Tel: +90 (236) 314 14 38, Faks: +90 (236) 314 14 37

**Ankara Factory:** 1.O.S.B. Nahcivan Cad. No:6, Sincan, Ankara/ Tel: +90 (312) 626 50 60

**Kayseri Production Facility:** İncesu OSB, Sultan Sazı 2.Cd. No:23, İncesu, Kayseri / Tel: +90 (352) 502 08 38, Faks: +90 (352) 502 08 37

**Diyarbakır Production Facility:** Elazığ Yolu Üzeri 22. Km OSB 2. Etap Yenişehir, Diyarbakır / Tel: +90 (412) 502 80 78